

# Unsinkable Floats

## PE Cylindrical-Shaped Buoy

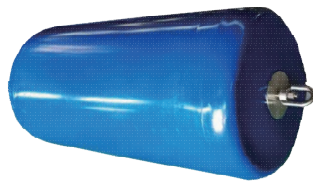

GMS



### Material

Linear Low Density Polyethylene (LLDPE UR644)

### Feature

- (1) The circular buoys of listed specifications are made of LLDPE UR644, which are with high impact strength and excellent resistance of temperature, corrosion and oxidation, and its service life under natural use conditions is 5 years or more.
- (2) Each buoy is integrally molded at one time, with seamless surface and good surface finish. The buoy is filled with not less than 15 kg/m EPS foam to ensure that even if there is damage caused by external impact, it will not sink due to the accumulation of a large amount of water inside.
- (3) The middle of the buoy passes through a  $\phi 20$  steel rod, with flanges(150\*10mm) and earrings at both ends. When connecting, it is connected with the adjacent floats through shackles connecting anchor chains to ensure that there is enough pulling force and the buoy will not be damaged.

GMS

### Application Scope

Floating marina/dock/jetty, aquatic plank and floating platforms etc.

General specifications can refer to the attached table, and special specifications can be customized according to customer requirements.

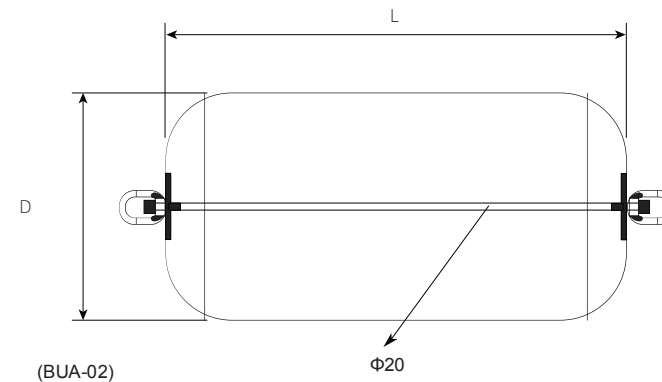
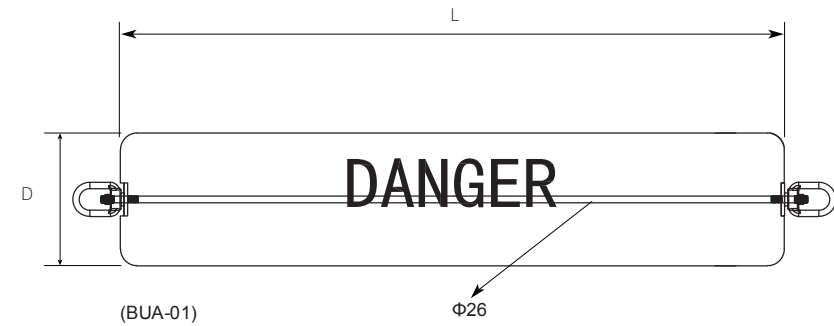

Item	Dimensions		Buoyancy in Half Immersion (kg)
	L(mm)	D(mm)	
BUA-01	1520	750	600
BUA-02	2000	400	270

### Notes:

- (1) We have ready-made molds for above dock floats, and special specifications and colors can be customized for production.
- (2) The average wall thickness of a dock float is not less than 5mm.

# Unsinkable Floats

## PE Spherical Drum



### Feature

- (1) The circular buoys of listed specifications are made of LLDPE UR644, which are with high impact strength and excellent resistance of temperature, corrosion and oxidation, and its service life under natural use conditions is 5 years or more.
- (2) Each buoy is integrally molded at one time, with seamless surface and good surface finish. The buoy is filled with not less than 15 kg/m<sup>3</sup> EPS foam to ensure that even if there is damage caused by external impact, it will not sink due to the accumulation of a large amount of water inside.
- (3) The middle of the buoy passes through a  $\phi 16$  steel rod, with flanges and earrings at both ends. When connecting, it is connected with the adjacent floats through shackles connecting anchor chains to ensure that there is enough pulling force and the buoy will not be damaged.

### Application Scope

Floating marina/dock/jetty, aquatic plank and floating platforms etc.

\*General specifications can refer to the attached table, and special specifications can be customized according to customer requirements.

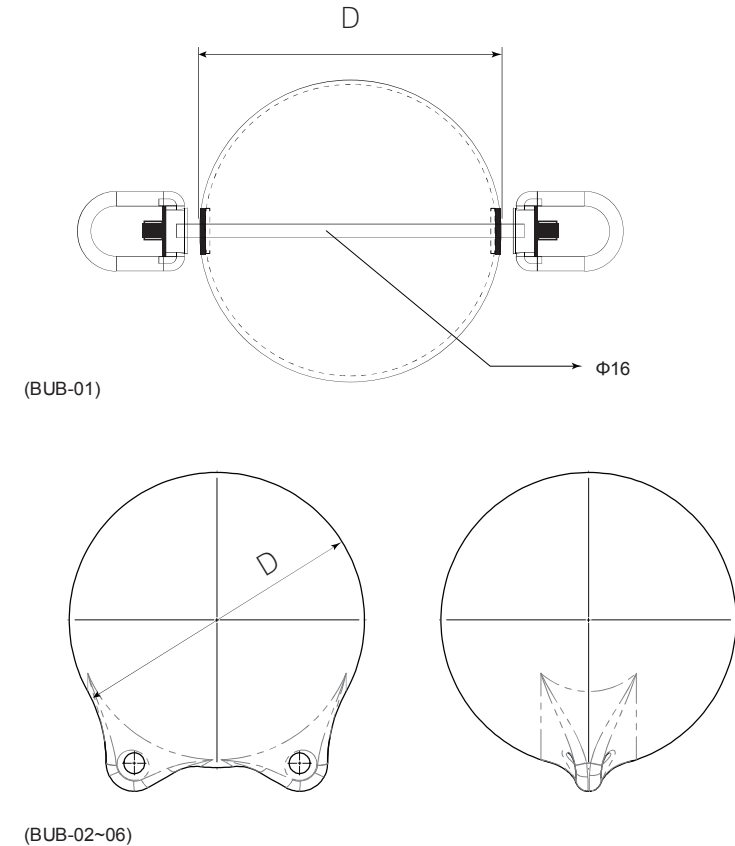

Item	Dimensions D(mm)	Buoyancy in Half Immersion (kg)
BUB-01	$\phi 400$	16
BUB-02	$\phi 500$	16
BUB-03	$\phi 600$	37
BUB-04	$\phi 800$	64
BUB-05	$\phi 1000$	148
BUB-06	$\phi 1100$	290

### Notes:

- (1) We have ready-made molds for above dock floats, and special specifications and colors can be customized for production.
- (2) The average wall thickness of a dock float is not less than 5mm.